

# Style F Sight Flow Indicator

This sight flow indicator is ideal for you to visually check the flow, presence, colour and condition of a liquid.

- ◆ Screwed and flanged connections
- ◆ Stainless steel flap and scale plate
- ◆ CE marked and fully PED compliant
- ◆ High temperature and pressure ratings
- ◆ Short lead times
- ◆ Designed and manufactured in the UK



## Application

With the flap and easy to read scale the style F sight flow indicator is used to check the flow rate of a liquid in a pipeline. It can be used in vertical or horizontal lines and is ideal as a plant safety device where you need to maintain a constant flow, for example in lubricating or cooling systems.

## Construction

The standard bodies are cast in either; carbon steel, 316 stainless steel or LG2 gun metal, though we can produce them in other materials.

The glass windows are held in place by stainless steel covers and screws, and sealed with PTFE gaskets, giving superior protection. For ease of maintenance the glasses can be individually removed and replaced.

For standard applications the indicator is fitted with toughened soda lime glass discs to BS3463 and rated to 16 bar. For steam and condensate we recommend toughened borosilicate glass, while for alkaline liquids mica discs can be used to protect the glass.

The sight glasses can be supplied with screwed connections to NPT, BSP parallel or taper. The standard flanges available are ANSI 150, ANSI 300 and PN16, though special flanges can be machined.

## Options

**Body** - Primary Flowpoints stock carbon, stainless steel and gun metal, but can supply sight glasses in special materials such as super duplex, hastelloy or low carbon steels. For particularly corrosive applications the body can be lined with PFA.

**Glass** - High pressure toughened soda lime to BS3463 rated to 40 bar 60 bar depending on size, toughened borosilicate to BS3463 or DIN7080 rated up to 16 bar. Higher pressures are available by reducing the viewing diameter. The high pressure range uses powder coated mild steel covers as standard, though stainless steel covers are available.

**Spring** - For high flow rates and vertical lines the flap can be spring loaded. This option will give three times the normal flow range.

**Gaskets** - Graphite gaskets are available if required.

**Fasteners** - We can also offer A4 stainless steel fasteners when necessary.

## Quality

All Flowpoints indicators are manufactured to the highest standards.

The quality system is independently audited by BSI and certified to ISO 9001. The indicators are fully PED compliant and CE marked where required. TUV are our external auditors for the Pressure Equipment Directive.

Full material traceability is maintained, material certificates and pressure test certificates are supplied on request.

# Specification Code

Code		Description							
SF			Stainless steel body BS 1504 316 C16						
CF			Carbon steel body BS 1504 161 GR480						
GF			Gunmetal body BS 1400 LG2 (screwed only)						
			Glass Material & Pressure Range						
H			Toughened soda lime glass to BS3463 rated to 16 bar (standard)						
B			Toughened soda lime glass to BS3463 rated to 40 bar						
HB			Toughened borosilicate glass to BS3463 rated to 6 bar						
			Toughened borosilicate glass to DIN 7080 rated to 16 bar						
			Flow Ranges - litres/minute						
			Indicator Size	Scale Reading	2	4	6	8	10
	008		8mm / 1/4"		2.0	3.0	3.7	5.0	
	010		10mm / 3/8"		2.5	3.1	3.8	5.7	
	015		15mm / 1/2"		3.0	4.5	5.5	8.0	20.0
	020		20mm 3/4"		3.0	5.0	6.0	9.5	20.0
	025		25mm / 1"		3.5	6.0	8.0	13.0	30.0
	040		40mm / 1 1/2"		8.5	12.5	16.7	25.0	55.0
	050		50mm / 2"		11.0	18.0	25.0	38.0	70.0
	080		80mm / 3"		29.0	46.0	64.0	118.0	230.0
	100		100mm / 4"		53.0	86.0	127.0	188.0	400.0
	150		150mm / 6"		55.0	95.0	154.0	250.0	430.0
	200		200mm / 8"		given on request				
			End Connection						
	A		ANSI 150						
	C		ANSI 300						
	N		PN16						
	1		BSP						
	2		BSPT						
	3		NPT						
	4		Socket Weld						

## Materials of Construction

- Covers - Stainless steel ASTM A351 CF8M (316)
  - Powder coated mild steel grade S355J2+N
- Internal Gasket - PTFE (stainless steel and carbon steel)
  - Klingersil C4400 (gun metal)
- External Gasket - Klingersil C4400
- Edge Protector - Klingersil C4400
- Fasteners (Standard) - A2 Stainless steel
  - (High Pressure) - High tensile steel
- Flap - 316 stainless steel

## Dimensions

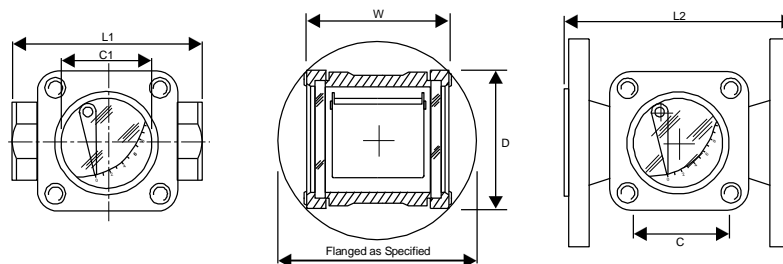

NOMINAL BORE	LENGTH L1	LENGTH L2	WIDTH W	DEPTH D	CLEARVIEW C
8/10mm (screwed)	85	N/A	63	60	42
15/20mm	85	130	63	60	42
25mm	95	140	72	66	48
40mm	120	180	102	84	62
50mm	150	220	118	106	77
80mm	N/A	260	160	170	100
100mm	N/A	260	196	170	100
150mm	N/A	360	304	220	150
200mm	N/A	460	370	280	200